

STANDARD DIE-CUTS: 13-1C - 1E

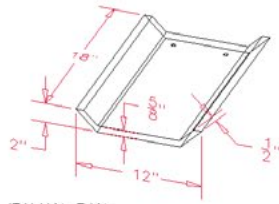

ITALIAN PAN
(TURN OVER FOR COVER)

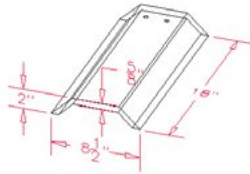

BERKELEY COVER
(TURN OVER FOR PAN)

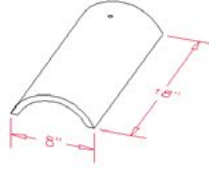

CORDOVA COVER

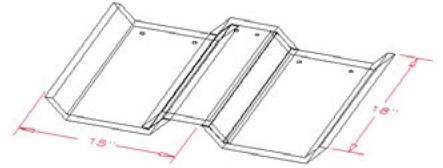

ITALIAN PANS WITH
BERKELEY COVERS
128 Pieces/Sq. (3" Headlap)
Approx. 1200 Lbs./Sq.

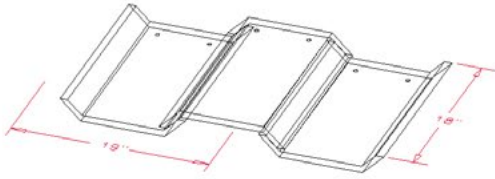

ITALIAN PANS WITH
ITALIAN COVERS
102 Pieces/Sq. (3" Headlap)
Approx. 1040 Lbs./Sq.

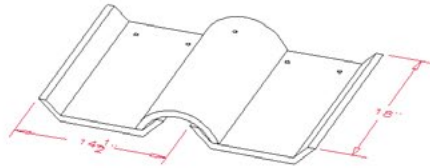

ITALIAN PANS WITH
CORDOVA COVERS
132 Pieces/Sq. (3" Headlap)
Approx. 1080 Lbs./Sq.

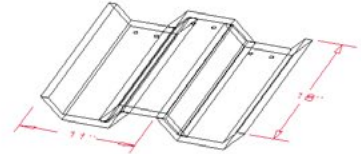

BERKELEY PANS WITH
BERKELEY COVERS
176 Pieces/Sq. (3" Headlap)
Approx. 1400 Lbs./Sq.

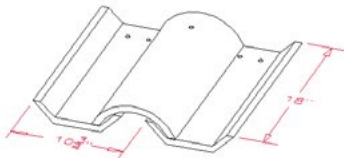

BERKELEY PANS WITH
CORDOVA COVERS
180 Pieces/Sq. (3" Headlap)
Approx. 1250 Lbs./Sq.

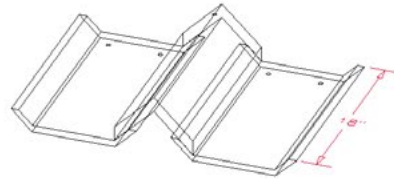

ITALIAN PANS WITH
90°"V"-RIDGE
148 Pieces/Sq. (3" Headlap)
Approx. 1600 Lbs./Sq.

ITALIAN AND BERKELEY CLAY ROOF TILE
(FILE NAME: 13-1.DWG)

STANDARD DIE-CUTS: 14-1

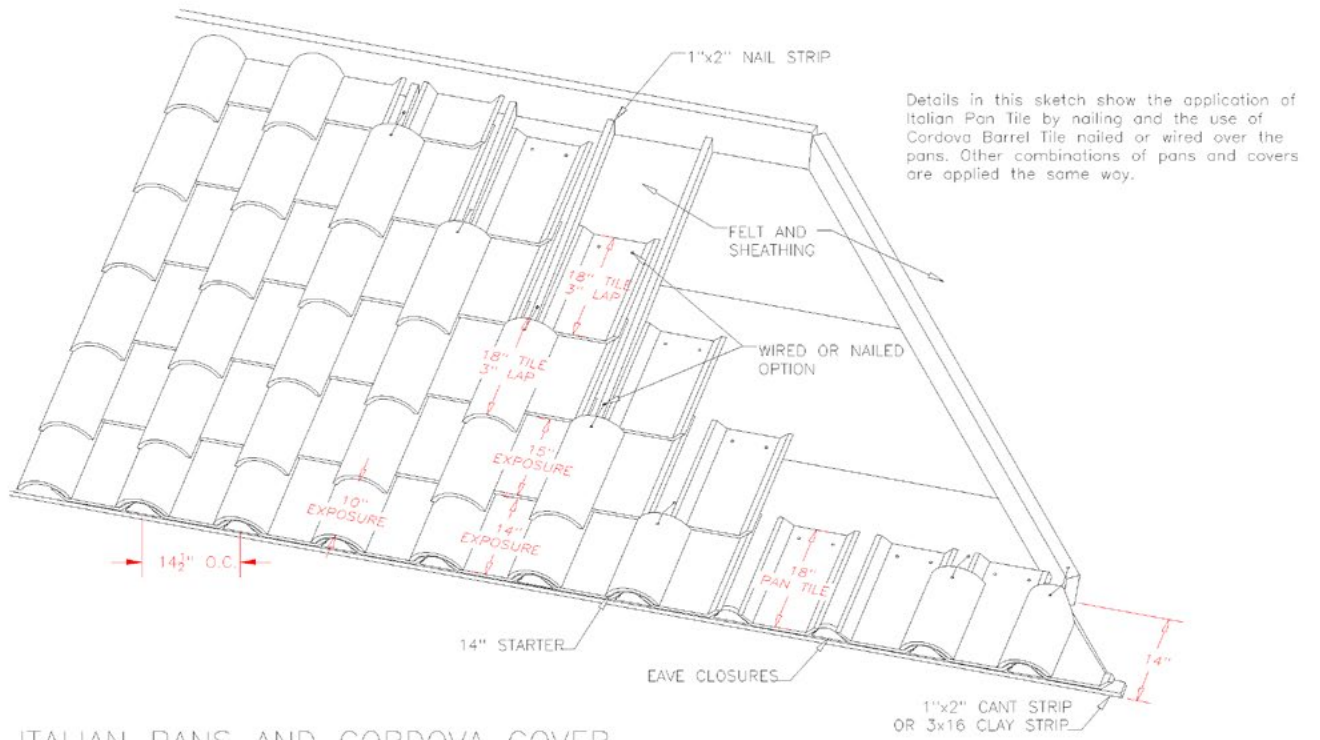

ITALIAN PANS AND CORDOVA COVER CONSTRUCTION DETAILS

(FILE NAME: 14-1.DWG)

STANDARD DIE-CUTS: 15-1

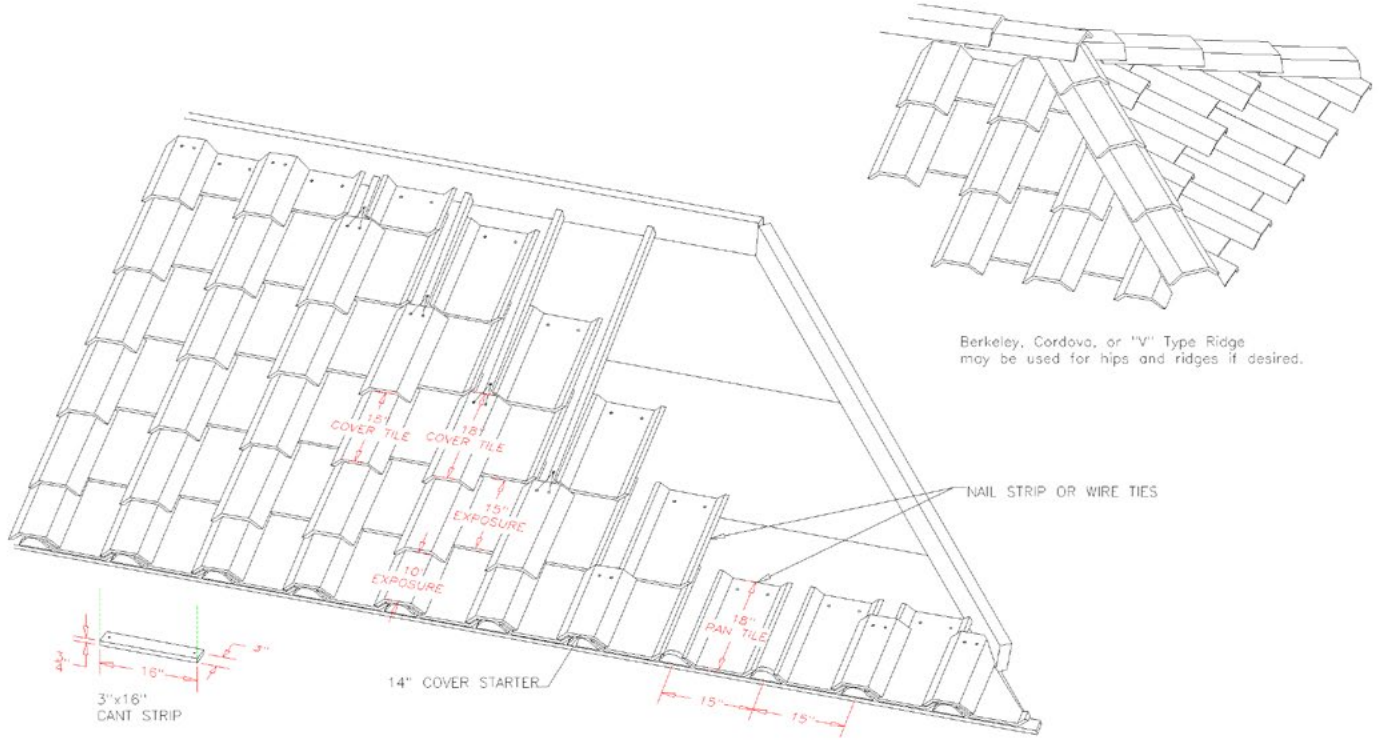

ITALIAN PANS AND BERKELEY COVERS
CONSTRUCTION DETAILS
(FILE NAME: 15-1.DWG)

STANDARD DIE-CUTS: 12-1

STANDARD DIE-CUTS: 12-2A

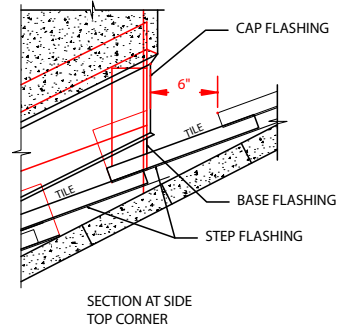
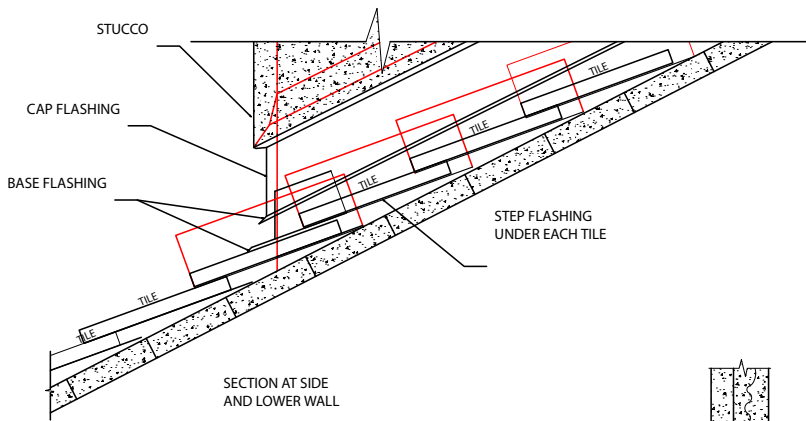

LINCOLN INTERLOCKING AND PLACER INTERLOCKING TILE CHIMNEY FLASHING DETAIL

(FILE NAME: 12-2.DWG)

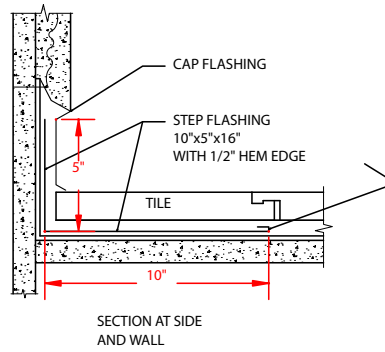

Base flashings, step flashings, and cap flashings around chimney walls should follow procedures illustrated in these drawings.

STANDARD DIE-CUTS: 12-3A & 12-3B

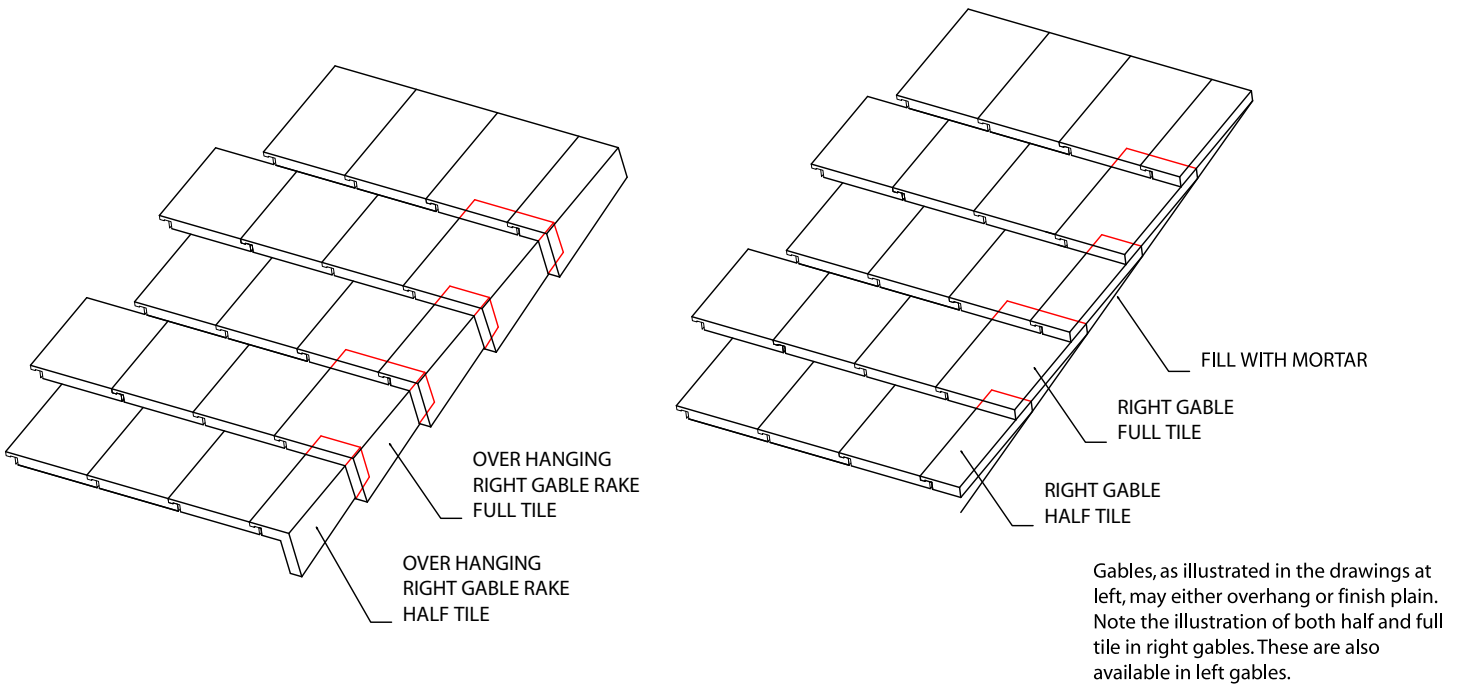

LINCOLN INTERLOCKING GABLE DETAIL

(FILE NAME: 12-3.DWG)