

USED FOR COVER
TILE, PAN TILE, RIDGES AND HIPS

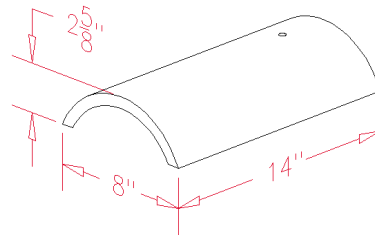

USED FOR STARTING COVER TILE

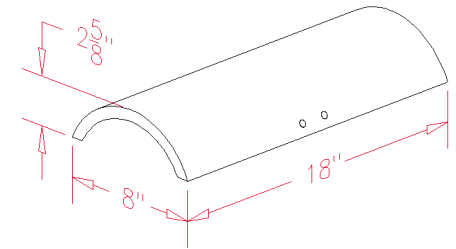

GABLE RAKE UNIVERSAL

Cordova roof tile is machine made. Each tile has a small hole close to one end which is used for fixing the tile to the roof. The same tile is used either as a pan or a cover tile merely by reversing its position. The same tile is also used for ridges and hips.

The starting cover tile is 14" long and is used only at the bottom course on first row of cover tile.

Double eaves tile is 6" long and is used on nearly all residential construction because of the enhanced appearance along the roof edge.

A gable rake tile is used wherever a roll gable is required. Two holes provide for nailing to the gable. Tiles are made left and right hand. Eave closure tiles may be used to fill the opening between pan tiles and eaves.

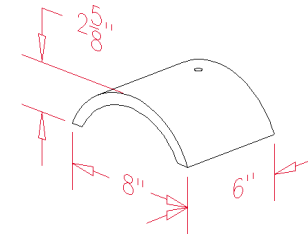

USED FOR DOUBLE EAVES

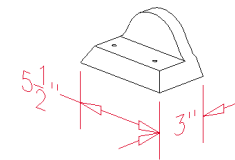

EAVE CLOSURE

CORDOVA CLAY TILE

(FILE NAME: 3-1.DWG)